

FILE NO : KSPCB/MA/ICO/10099120/2025

Date of issue : 18-03-2025



KERALA STATE POLLUTION CONTROL BOARD

CONSENT TO

OPERATE/AUTHORISATION/REGISTRATION

ISSUED UNDER

The Water (Prevention & Control of Pollution) Act, 1974

The Air (Prevention & Control of Pollution) Act, 1981

and

The Environment (Protection) Act, 1986

As per Application No. : 10099120

Dated : 04-03-2025

To

**GRANITE BUILDING STONE QUARRY OF SRI. MUHAMMED SHEREEF
NECHIKKAD KUNNU,,MOORKKANAD VILLAGE,,KOLATHOOR
POST,,MALAPPURAM DT.,**

Consent No. : KSPCB/MA/ICO/10099120/2025

Valid Upto : 28-02-2030

1. GENERAL

1.1. This integrated consent is granted subject to the power of the Board to withdraw consent, review and make variation in or revoke all or any of the conditions as the Board deems fit

1	VALIDITY	28-02-2030
2	Name and Address of the establishment	GRANITE BUILDING STONE QUARRY OF SRI. MUHAMMED SHEREEF NECHIKKAD KUNNU,,MOORKKANAD VILLAGE,,KOLATHOOR POST,,MALAPPURAM DT., E-Mail : sssolutions67@gmail.com Contact Number : 9995757550
3	Occupier Details	MOHAMMED SHEREEF K K MOHAMMED SHEREEF K.K, S/O MOIDEEN, KUTTIKADAN HOUSE, ATHAVANAD PO, THIRUNAVAYA VILLAGE MALAPPURAM DT, E-Mail : sssolutions67@gmail.com Contact Number :
4	Local Body	MOORKKANAD
5	Survey Number	291/3-29
6	Village	Moorkkanad
7	Taluk	Perinthalmanna
8	District	MALAPPURAM
9	Capital Investment(Rs in Lakhs)	150.0
10	Scale	Small
11	Category	RED
12	Annual fee(Rs)	25000.0
	Total Fee remitted(Rs)	137500.0
13	Activity	BLASTED RUBBLES (5 YEARS)- 392325 Metric Tonnes
14	Machinery details	NIL

2. GENERAL CONDITIONS

1. This consent is granted on the basis of the application, site plan, affidavit and other documents furnished by the applicant. The consent is liable to be revoked if the documents submitted are forged and/or in case of non compliance with the Board's norms.
2. The application for renewal of consent shall be submitted online two months in advance of the expiry date of the validity of the consent. Late application will be accepted only with a fine as applicable.
3. The applicant shall comply with the instructions that the Board may issue from time to time regarding the prevention and control of air, water, land and sound pollution.
4. The location of the establishment/ outlet shall be as per the site plan attached. No change or alteration of the unit is to be made without the prior written permission of the Board. Any change in the particulars furnished and/or in the identity of the occupier/authorized agent is to be intimated to the Board forthwith.
5. For the rented building, consent will be valid only during the period the rent agreement is valid. The rent agreement shall be renewed from time to time.
6. The consentee shall put up a sign board of size 6x4 ft. near the main entrance of the plant to display the name of the unit and important consent conditions.
7. In case of discharge/apprehended discharge of any water/air pollutant or hazardous waste due to any accident or other unforeseen act or event, it shall be immediately intimated to the Board and the consentee/authorisee shall make all possible efforts to mitigate/prevent/remediate the discharge.
8. Pollution control equipments shall be operated with backup power during power.
9. If operations are done with backup power, the generator shall have adequate capacity to run all associated pollution control devices.

3. Conditions as per Water (Prevention and Control of Pollution) Act, 1974

1. Water consumption-NA
2. Effluent generation-NA
3. Mode of disposal of treated effluent : Septic tank, soak pit
4. There shall not be any discharge of trade effluent from the unit
5. Soak pits shall be provided for the disposal of excess treated water. Soak pit shall have concreted bottom, honey comb brick work or perforated ring side wall, 75cm thick 2mm sand envelope outside it.

4. Conditions as per Air (Prevention and Control of Pollution) Act, 1981

1. Air pollution control measures provided shall be maintained properly.

Stack No	Source of emission	Emission Rate (Nm ³ / Hr)	Stack height above ground level	Stack height above roof level	Control equipment
1	NIL				

2. All operations likely to produce dust or noise shall be carried out within sufficiently closed and insulated premises.
3. There shall be no fugitive emissions from the premises.

5. Conditions as per Environment (Protection) Act, 1986

1. Necessary arrangement for collection, segregation, storage, handling and disposal of solid waste including garbage shall be provided in accordance with the provisions of the Solid Waste Management Rules, 2016.
2. Biodegradable waste shall be segregated from non biodegradable waste at source. Facilities namely biobins/aerobins/biogas plant shall be provided for the biodegradable waste. Facility shall be provided for

the disposal of non biodegradable wastes to authorised collectors namely Haritha Karma Sena for the disposal of wastes for authorised treatment.

3. Plastic Waste Management Rules, 2016 and amendments shall be followed for the management of plastic waste. Single use plastic ban as per notifications and orders for Kerala shall be strictly followed.
4. Hazardous waste generated if any, shall be disposed of in compliance with the provisions of the Hazardous and other Wastes (Management and Trans boundary Movement) Rules, 2016.
5. The hazardous waste generated the unit shall be sent to the authorised recycler/ CTSDf owned by KEIL for disposal and shall not be stored in the unit beyond the period specified in the rules.
6. Hazardous waste manifest in Form 10 as specified in the rules shall be submitted periodically.
7. Waste batteries shall be disposed of as per the Battery Waste Management Rules, 2022
8. E-wastes shall be disposed of as per the provisions of E-waste management Rules, 2016 and amendments.
9. Provisions of the Noise Pollution (Regulation and Control) Rules 2000 shall be followed with.
10. Trees and curtain plants shall be planted within and along the boundary of the premises and shall be maintained with due care.
11. Water and energy conservation measures shall be adopted.
12. Rainwater harvesting and utilization of harvested water shall be done.
13. Environmental statement shall be submitted in Form V for each financial year ending on March 31st. Annual reports under Bio medical Waste Management Rules, 2016; E Waste Management Rules 2016; Plastic Waste Management & Handling Rules, 2016; Solid Waste Management Rules 2016; Construction & Demolition Waste Management Rules, 2016; Hazardous & Other waste (Management & Transboundary Movement Rules, 2016 shall be submitted on or before 30 th June, 30 th June, 30th April, (Local bodies to PCB-31st June; 30 th June, 30 th June respectively.

6. SPECIFIC CONDITIONS

1. Location and extent of quarry shall be as per the approved mine plan.
2. Permanent fence made of wire mesh shall be provided and maintained along the boundary of the approved quarrying area.
3. The concentration of particulate matter PM 10 and PM 2.5 at the boundary of the premise shall not exceed $100\mu\text{g}/\text{m}^3$ and $60\mu\text{g}/\text{m}^3$ respectively.
4. After completion of quarrying, the land may be reclaimed as per the mining plan approved by the Department of Mining and Geology.
5. The applicant shall comply with the instructions that the Board may issue from time to time regarding the prevention and control of Air, Water, Land and Sound Pollution.
6. No change or alteration of the quarrying area is to be made without the prior written permission of the Board. Any change in the particulars furnished and/or in the identity of the occupier/ authorized agent is to be intimated to the Board forthwith.
7. Quarrying operations shall be started only after obtaining the all the statutory clearances required, which shall be valid throughout the period of operations
8. The quarry should not be operated between 6.00 p.m. and 6.00 a.m.
9. The applicant shall put up a 6 ft. x 4 ft. signboard near entrance to the quarry for displaying the name of the quarry and owner, production details and time of the day when blasting is permitted to be undertaken.
10. The applicant shall submit copies of all relevant permits/ lease/certificate/licences periodically to this office to ensure the validity of this consent.

Reference:-

1. Environmental clearance- EC24C0108KL5377467N dated 01.03.2025
2. Explosive licence No . - E/SE/KL/22/97(E91422) dated 17/05/2024 valid till 31.03.2029
3. Mining And Geology letter no: DMG/1369/2023-M4 dated 19.02.2024

SIGNATURE OF ISSUING AUTHORITY

ENVIRONMENTAL ENGINEER



To

M/s GRANITE BUILDING STONE QUARRY OF SRI. MUHAMMED SHEREEF
NECHIKKAD KUNNU, MOORKKANAD VILLAGE, KOLATHOOR POST, MALAPPURAM DT.
E-Mail : sssolutions67@gmail.com
Contact Number : 9995757550

1.This digitally signed document is legally valid as per the Information Technology Act 2000

2. For verifying this document please go to www.keralapcbonline.com and search using Certificate Number/name of the unit/Application Number in “Certificate Verification” link in the home page of the Board’s Phoenix website.

No: 637/4

FILE NO : TLKPTM/ 715/2023-CA
DISTRICT : MALAPPURAM
TALUK : PERINTALMANNA
VILLAGE : MOORKKANAD

SURVEY MAP

BLOCK NO : 003
SY NO:291/3-29
PROPOSED LEASE AREA = 1.2916 Ha

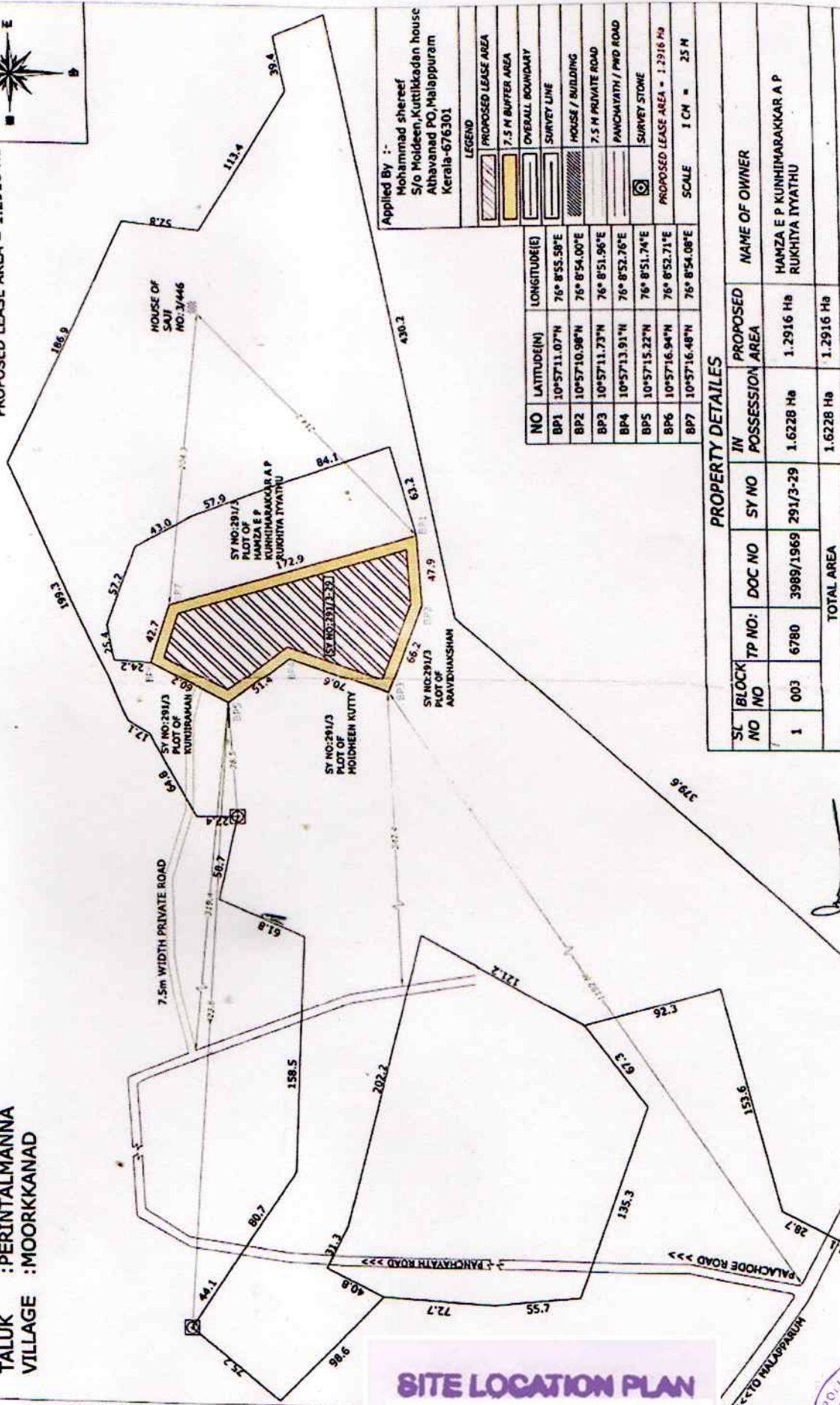

SITE LOCATION PLAN

ENVIRONMENTAL ENGINEER

Applied By :-
Mohammad shereef
S/o Moldeen, Kuttikkadan house
Athavanad PO, Malappuram
Kerala-676301

LEGEND

	PROPOSED LEASE AREA
	7.5 M BUFFER AREA
	OVERALL BOUNDARY
	SURVEY LINE
	HOUSE / BUILDING
	7.5 M PRIVATE ROAD
	PANCHAYATH / PWD ROAD
	SURVEY STONE
	PROPOSED LEASE AREA = 1.2916 Ha
	SCALE 1 CM = 25 M

NO	LATITUDE(N)	LONGITUDE(E)
BP1	10°57'11.07"N	76° 8'55.58"E
BP2	10°57'10.98"N	76° 8'54.00"E
BP3	10°57'11.73"N	76° 8'51.96"E
BP4	10°57'13.91"N	76° 8'52.76"E
BP5	10°57'15.22"N	76° 8'51.74"E
BP6	10°57'16.94"N	76° 8'52.71"E
BP7	10°57'16.48"N	76° 8'54.08"E

PROPERTY DETAILS

Sl. NO	BLOCK NO	TP NO:	DOC NO	SY NO	POSSESSION AREA	PROPOSED AREA	NAME OF OWNER
1	003	6780	3989/1969	291/3-29	1.6228 Ha	1.2916 Ha	HAMZA E P KUNHIMARAKKAR A P RUKHITHA IYATHU
TOTAL AREA					1.6228 Ha	1.2916 Ha	

MAYA P.M
TAHSILDAR
PERINTALMANNA

21/3/24

AJEESH. H.
VILLAGE OFFICER
MOORKKANAD

THIS PLAN IS ISSUED TO SUBMIT BEFORE MINING GEOLOGY DEPARTMENT SIAA / DEIAA